



Stanmore Hill

Stanmore

£349,000

A top floor flat available in a characterful building on Stanmore Hill with Davidson Frost-Wellings.

The flat is in a converted period building with beautiful features including turreted window, pitched ceilings and wooden floors. There is a large, bright master bedroom with built in storage, eaves storage and still lots of space for freestanding furniture. There is also a charming reception room with a five-windowed bay providing lots of natural light and views down Stanmore Hill. There is also a separate kitchen and a large bathroom with lots of eaves storage.

There is also a communal roof terrace offering stunning views over London.

Long lease in excess of 150 years on completion.
Ad hoc service charges.
Peppercorn ground rent.
Harrow Council Tax Band C.

- One bedroom
- Characterful building
- Separate kitchen
- Communal roof terrace
- 725 sq ft in total
- Long leasehold

Viewing

Please contact our Davidson Frost-Wellings Office on 020 8954 8806 if you wish to arrange a viewing appointment for this property or require further information.



1



1



1



D

Floor Plan

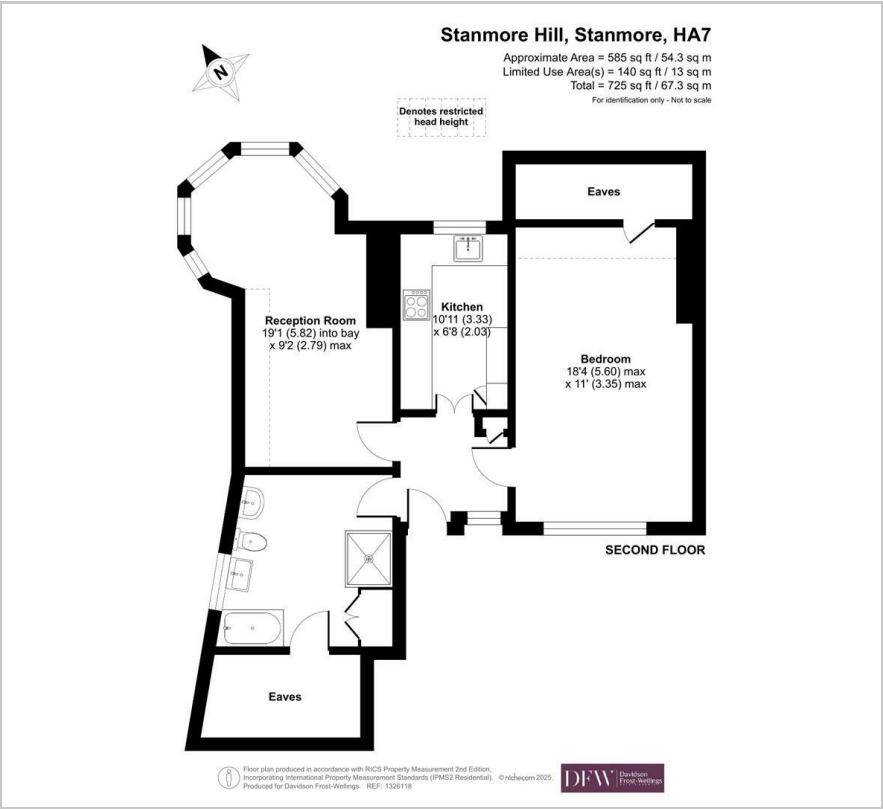

Area Map

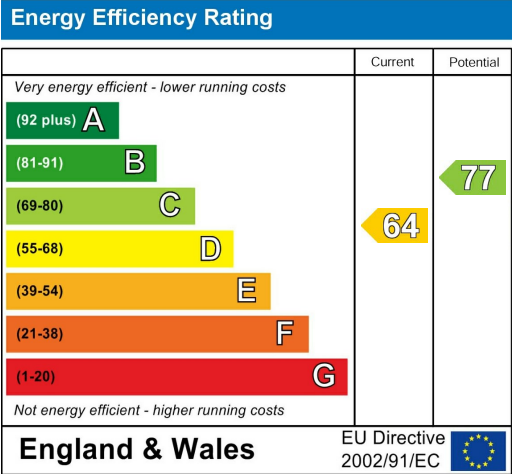
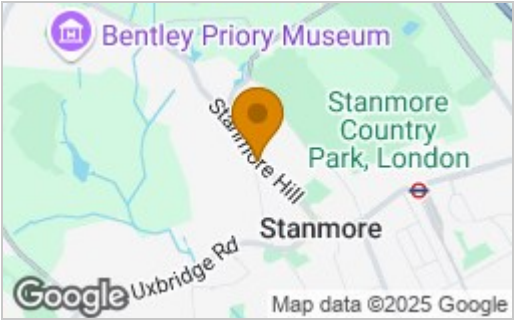

These particulars, whilst believed to be accurate are set out as a general outline only for guidance and do not constitute any part of an offer or contract. Intending purchasers should not rely on them as statements of representation of fact, but must satisfy themselves by inspection or otherwise as to their accuracy. No person in this firms employment has the authority to make or give any representation or warranty in respect of the property.